

My e-learning does not display. What must I do?

A pop-up is a small web browser window that appears on top of the website you are viewing. The presentations viewed during the training are set to open in a new window and is therefore classified as a pop-up. Pop-up blockers must be disabled or be set to allow from Sage University for courses to function properly. To allow pop-up windows from Sage University, follow the instructions below for your browser.

[Google Chrome](#) | [Microsoft Edge](#) | [Mozilla Firefox](#)

Chrome

- Click the **Chrome menu** button on the far right of the browser address bar and select the **Settings** option.

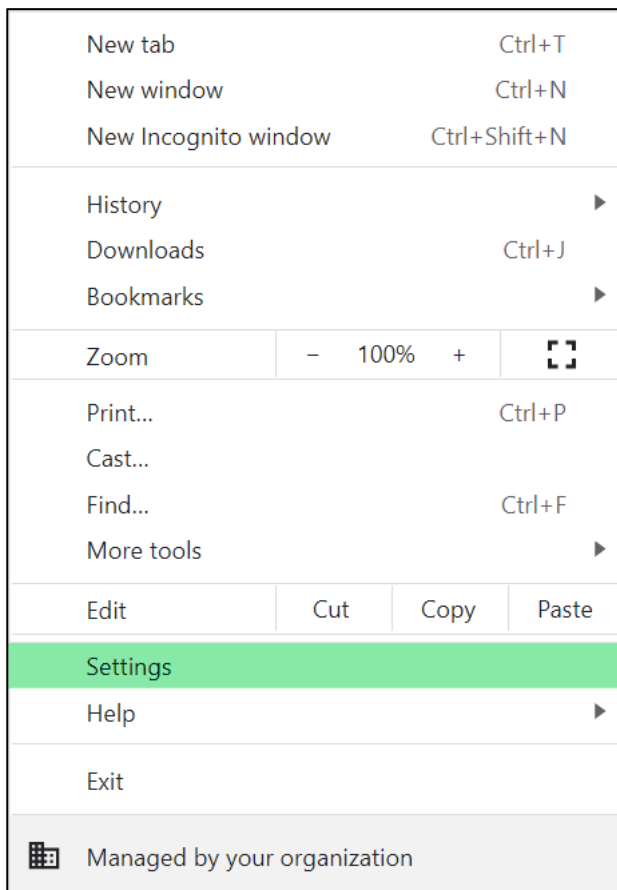

- In the **Privacy and security** section, click on **Site Settings**.

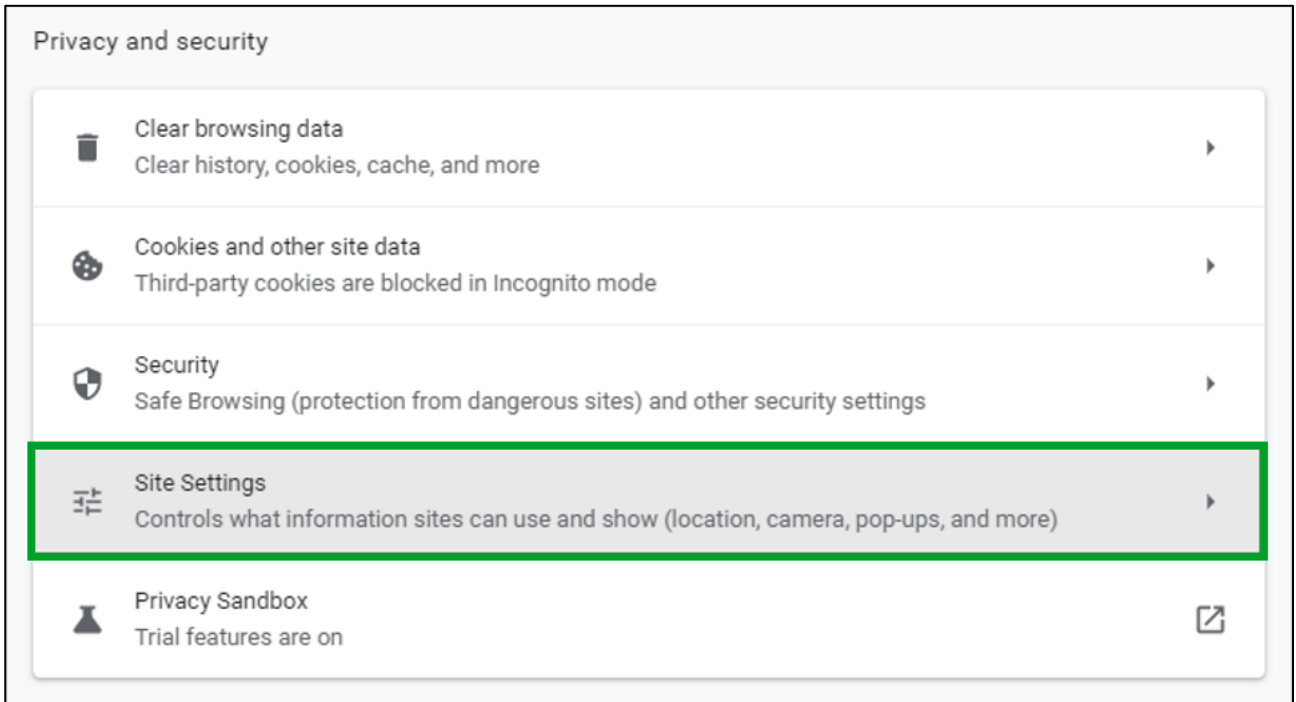

- Scroll down to the **Content** section and click on **Pop-ups and redirects**.

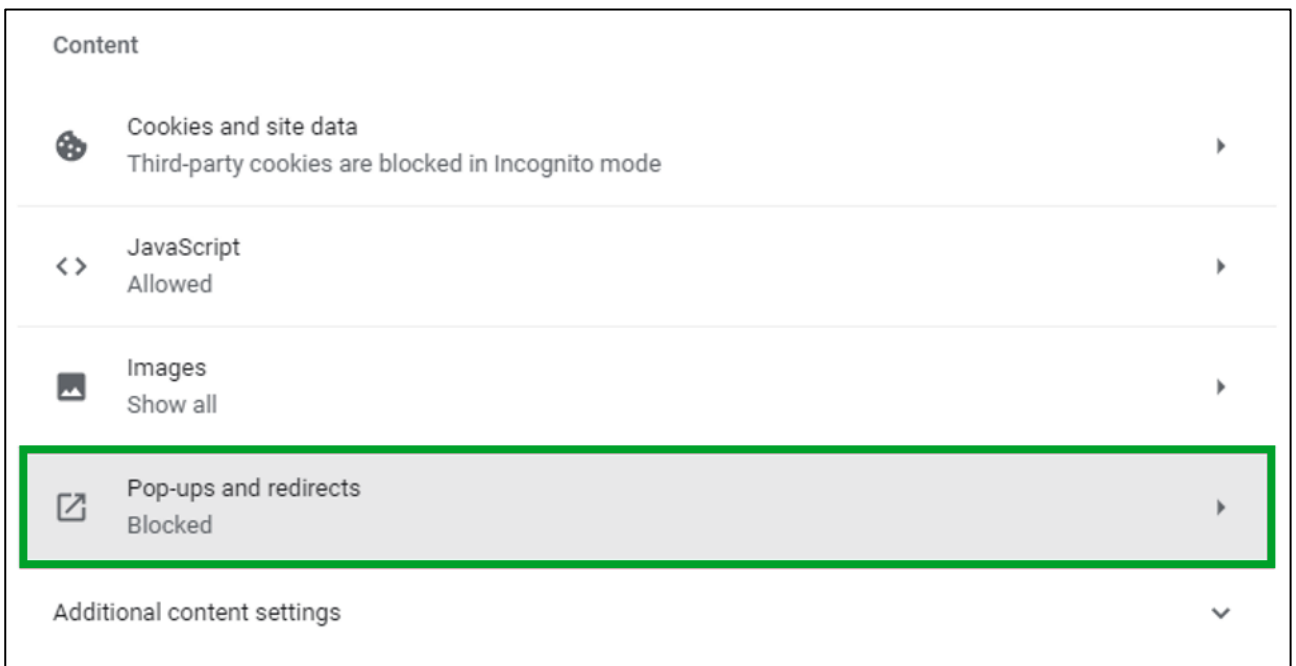

- Click on **ADD** next to the **Allow** heading.



- In the **Site** field, enter **sageu.csod.com** and click on **Add**.

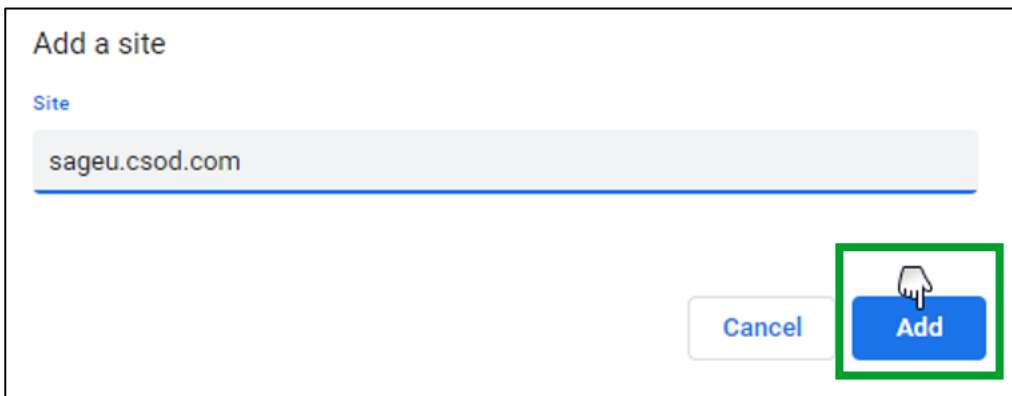

- Click on the **Close** button on the far right of the browser address bar.

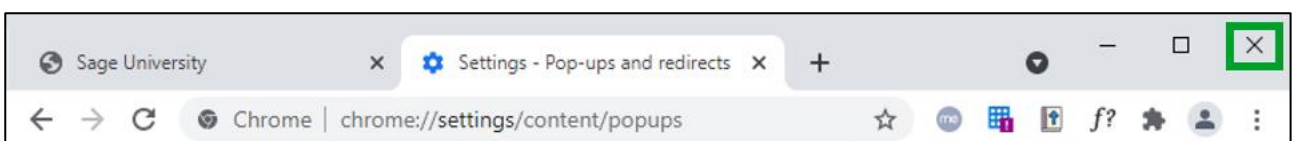

Microsoft Edge

- Click the **browse icon** on the far right of the browser address bar and select **Settings**.

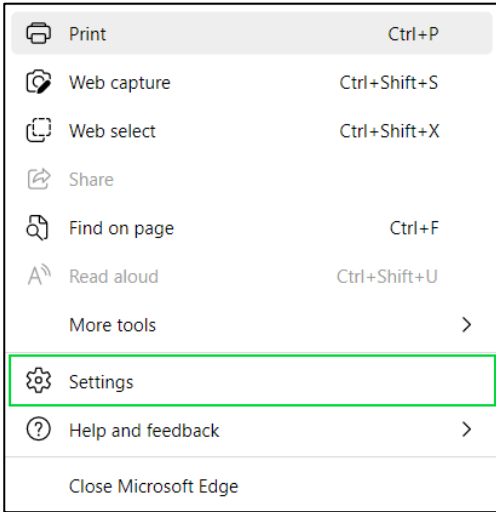
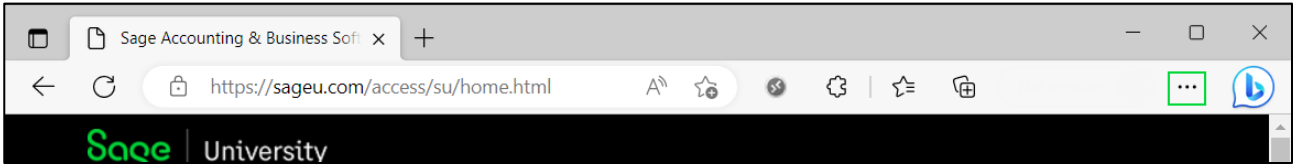

- Click on the **Cookies and site permissions** tab and then click on **Pop-ups and redirects**.

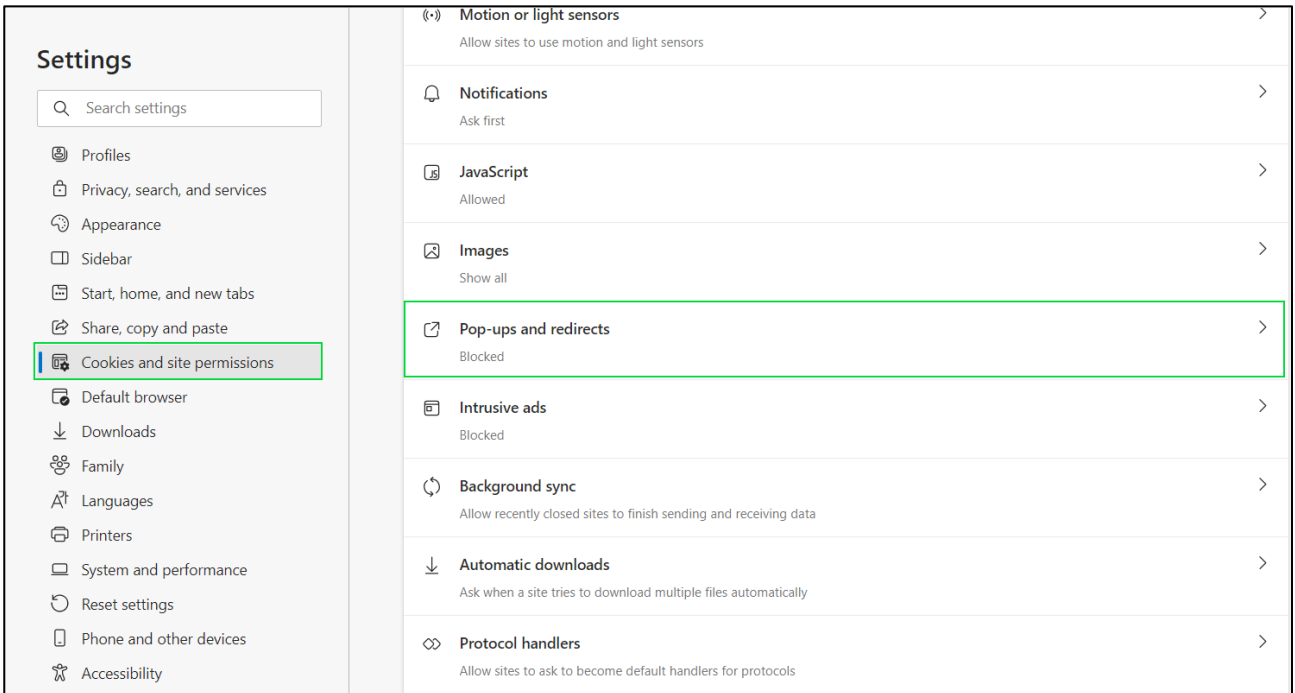

- On the **Allow** section, click on the **Add** button:

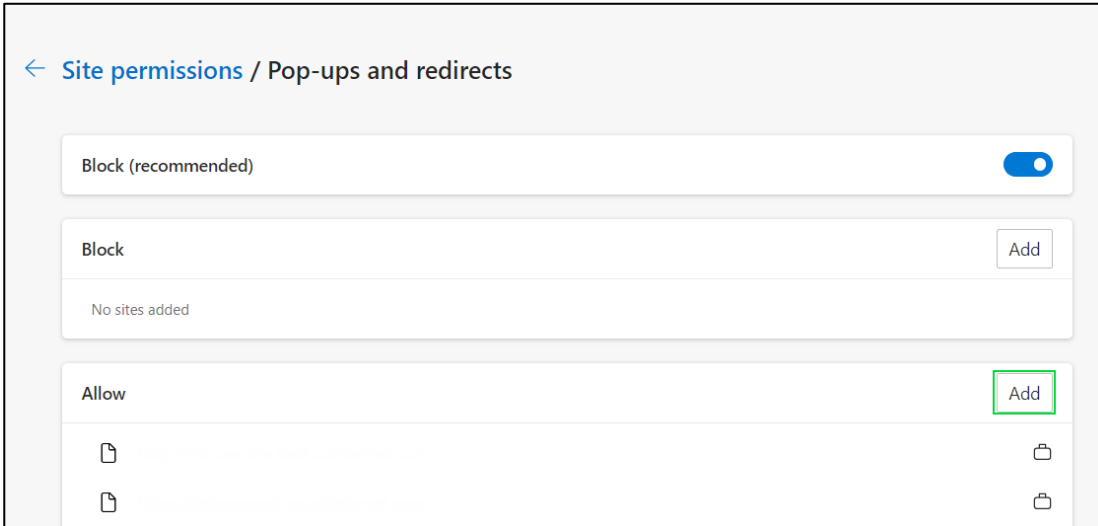

- The **Add a site** screen will be displayed. In the **Site** field, enter **sageu.csod.com** and click on **Add**.

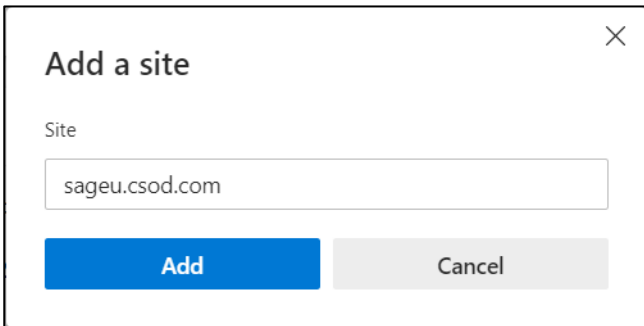

- Click on the **Close** button on the far right of the browser address bar.

Mozilla Firefox

- Click the **hamburger menu** button on the far right of the browser address bar and select the **Settings** option.

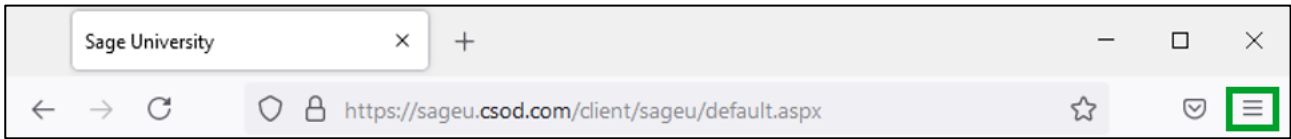

- Click on **Privacy & Security** and scroll down to **Permissions**. Click on **Exceptions** next to **Block pop-up windows**.

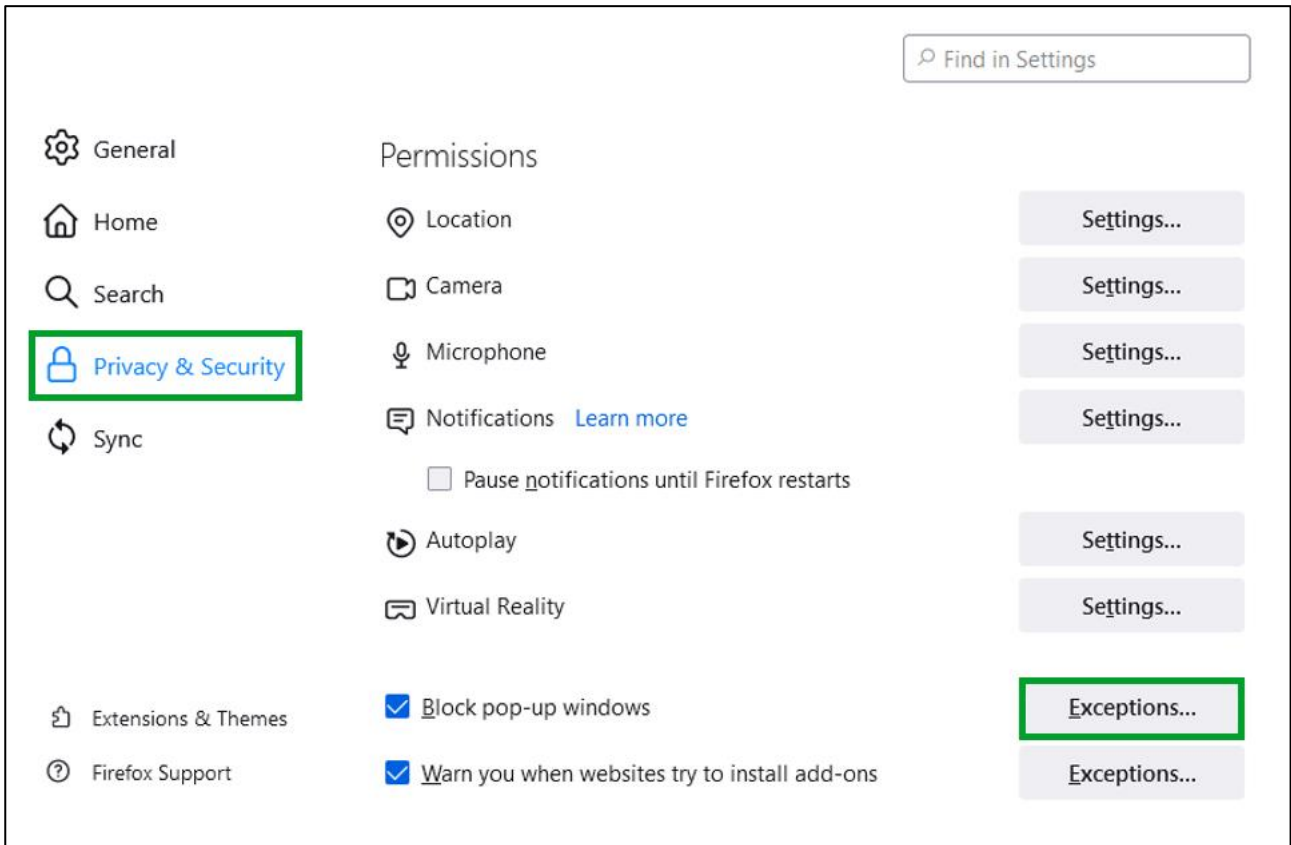

- In the **Address of website** field, enter **sageu.csod.com** and click on **Allow**.

Allowed Websites - Pop-ups ✕

You can specify which websites are allowed to open pop-up windows. Type the exact address of the site you want to allow and then click Allow.

Address of website

sageu.csod.com

Allow

Website	Status

Remove Website Remove All Websites

Save Changes Cancel

- Click on **Save Changes**.

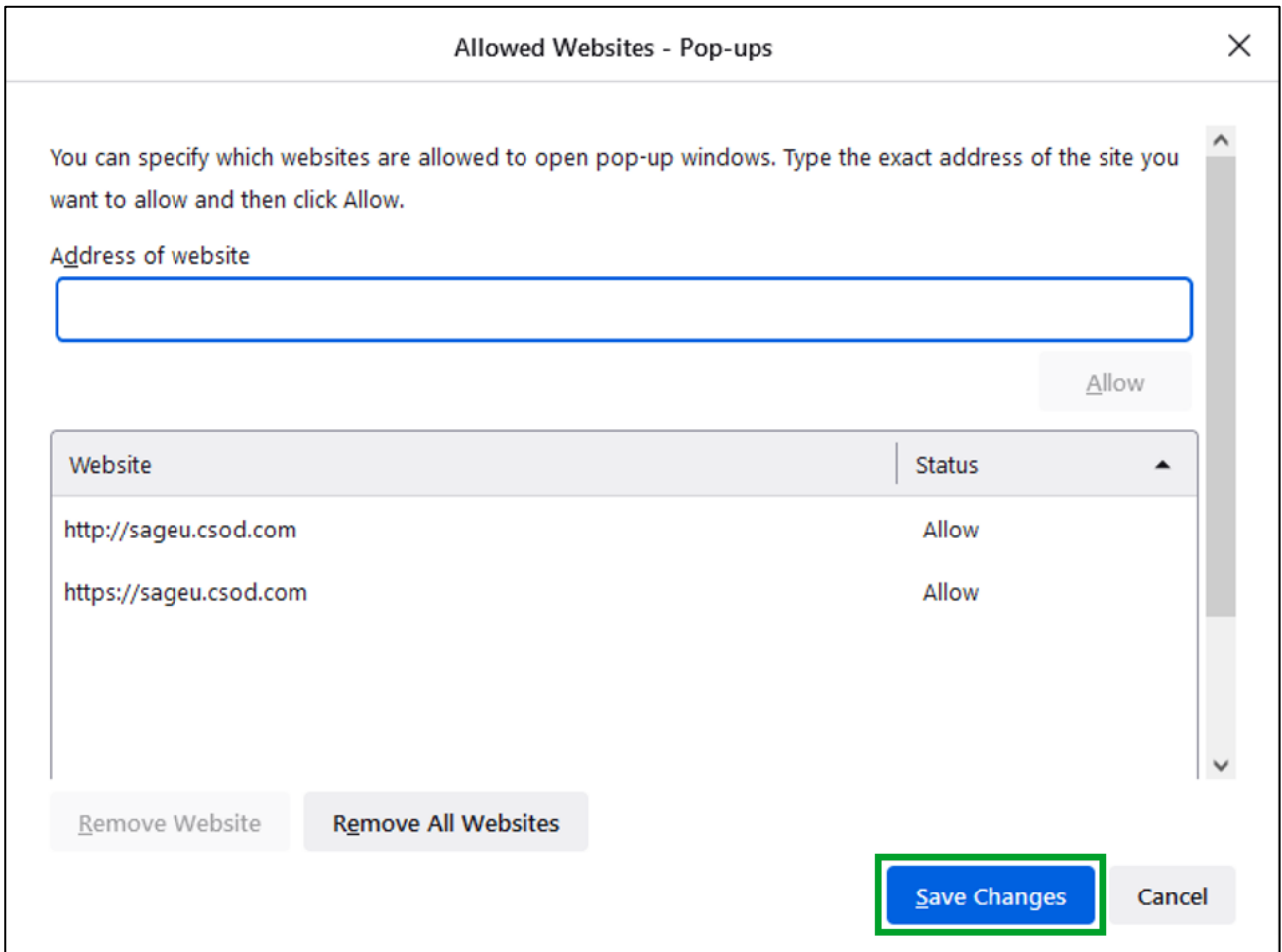

- Click on the **Close** button on the far right of the browser address bar.



Sage

© Sage Group plc or its licensors. All rights reserved.

Document Version: April 2023